

RIVETKING® RIVET SETTING EQUIPMENT

HANDSETS

Handsets are used for prototyping or low volume installation of Semi Tubular rivets. Handsets can be used with a hammer or they can be modified by the user to fit in a press.

Diameter of Rivet	A	B
	Tip Diameter	Length
Nominal	Nominal	Nominal
3/32 - .094	0.166	0.071
1/8 - .125	0.219	0.094
5/32 - .156	0.273	0.117
3/16 - .188	0.327	0.140
7/32 - .219	0.385	0.165
1/4 - .250	0.438	0.188
9/32 - .281	0.492	0.211

All diameters given in inches

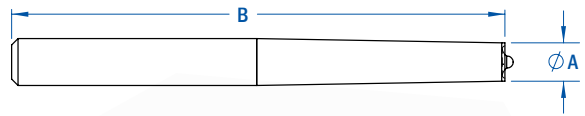

RIVETING HAMMERS

Rivet Hammers are used as an economical way to apply soft solid rivets in diameters less than 3/16". The patented shock reducing air hammer will apply rivets with a hardness less than Rb65 max. The air hammer delivers more than 1000 blows per minute to insure the rivet is set properly. The riveter comes in a blow mold kit equipped with 3/32", 1/8", 5/32", 3/16" round face punches. The quick change feature is convenient and is ergonomically designed for operator comfort.

Diameter of Rivet	A	B
	Tip Diameter	Length
Nominal	Nominal	Nominal
3/32 - .094	0.166	0.071
1/8 - .125	0.219	0.094
5/32 - .156	0.273	0.117
3/16 - .188	0.327	0.140
7/32 - .219	0.385	0.165
1/4 - .250	0.438	0.188
9/32 - .281	0.492	0.211

All diameters given in inches



AUTO FEED RIVETING MACHINES

The RivetKing ESI Riveter is one of the most modern and efficient riveters designed. The ESI series is designed to apply Semi Tubular rivets, however, depending on the diameter and material, it also has the capacity to handle self piercing rivets and solid rivets. The machines is simple to maintain; having only 8 moving parts, and a choice of feed systems depending on the size and shape of the rivets. It is built around a steel weldment, and is available as a pedestal or bench model, with several anvil brackets to accommodate a versatile range of parts.

Machine	Rivet Diameter Capacity	Rivet Length Capacity	Stroke	Standard Throat Depth	Optional Throat Depth	Bench Model	Pedestal Model	Applied Force
Model#	Min - Max	Min - Max	Inches	Standard	Optional	W" x D" x H"	W" x D" x H"	Configuration
P-125	.040" - .140"	.090" - .500"	2"	9"	18" or 24"	10" x 22" x 24"	28" x 20" x 61"	Pneumatic
P-250	.125" - .250"	.125" - 1.625"	3"	12"	18" or 24"	18" x 22" x 32"	18" x 24" x 34"	Pneumatic
P-255	.140" - .250"	.125" - 3.250"	5"	16"	18" or 24"	18" x 36" x 34"	24" x 36" x 78"	Pneumatic
P-312	.250" - .312"	.250" - 3.250"	5"	12"	-	-	30" x 36" x 80"	Air / Oil

ALL DIAMETERS GIVEN IN INCHES

OPTIONAL EQUIPMENT:

- Footswitch
- Double Palm Buttons
- FingerGuard
- Air Operated Anvil Pin
- Vibe Bowl

Can be designed as a multiple head system.



P-125 Bench Model w/ Vibe Bowl

P250-P-24 Deep Throat Pedestal w/ Rotary Hopper

P255-P Pedestal w/ Vibe Bowl and Air Operated Anvil Pin

Rotary Hopper

Vibratory Bowl Feeder

Air Operated Anvil Pin Option