

RIVETKING® STEMLOCK®

THE FOLLOWING PRODUCT IS COVERED UNDER THE FOLLOWING PATENT/TRADemark: 3,504,665

STRUCTURAL BLIND RIVETS • STEEL/ ALUMINUM

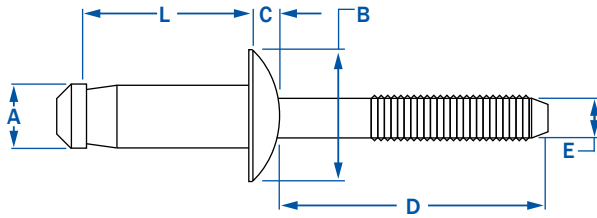

AVAILABLE MATERIALS: ALL STEEL, ALL ALUMINUM DOME HEAD

The Stemlock® is an advanced structural fastening solution that has among the highest shear and tensile values available because the mandrel is locked into the shear plane. The internal locking mechanism insures positive mandrel retention and will break flush with the head. The Stemlock® is designed to form a bearing surface flange at the rear side of the substrate. This rear flange is perfect for thin sheets or imperfect holes offering impressive clamp up forces without deforming the substrate.



RIVET SIZE	PART NUMBER	GRIP RANGE MIN. - MAX.	RIVET LENGTH MAX	STANDARD FLANGE			MANDREL DIA. DIA.	BACKSIDE CLEARANCE MIN.	SHEAR STRENGTH LBF	TENSILE STRENGTH LBF	
				A	B	C					E
				BODY DIA.	HEAD DIA. MAX.	HEAD HEIGHT MAX.					
1/4"	STM-0812	.068 - .138	.539	.263 .271	.530	.110	N/R	.480	3,820	2,090	
	STM-0813	.110 - .189	.590								
	STM-0814	.132 - .211	.612								
	STM-0815	.189 - .268	.669								
	STM-0817	.268 - .346	.747								
	STM-0818	.295 - .374	.775								
	STM-0819	.346 - .425	.826								
	STM-0821	.425 - .504	.905								
1/4"	STMA-0812	.068 - .138	.539	.263 .271	.530	.110	N/R	.480	1,225	606	
	STMA-0813	.110 - .189	.590								
	STMA-0814	.132 - .211	.612								
	STMA-0815	.189 - .268	.669								
	STMA-0817	.268 - .346	.747								
	STMA-0818	.295 - .374	.775								
	STMA-0819	.346 - .425	.826								
	STMA-0821	.425 - .504	.905								



1.800.BUY.RIVET