

RIVETKING® QUIKSNAP®

NICKEL PLATED BRASS HEAD/ STAINLESS MANDREL

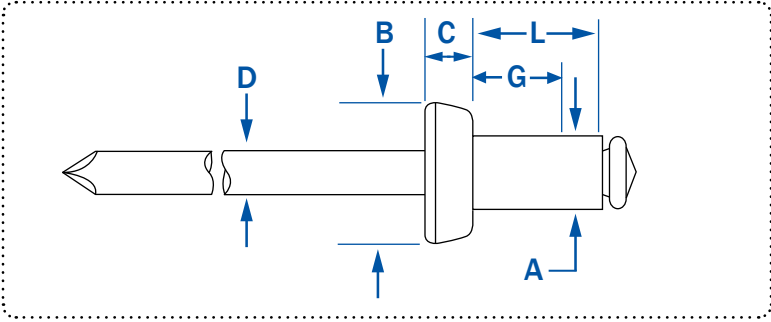

The innovative RivetKing® Quick-Snap™ is the ideal companion to the standard canvas snap used on truck bodies, convertibles, boats, cars and many other applications. The snap head is brass, with a bright nickel plating. The mandrel is stainless steel. Requires T105-734 Nosepiece.

The extract force is a minimum of 5 lbs.

RIVET SIZE	A		D		B		C		L		G		TYPICAL ULTIMATE STRENGTH		CARTON	
	HOLE SIZE AND DRILL NO.	MANDREL DIA. NOM.	FLANGE DIA. NOM.	HEAD HEIGHT MAX.	BARREL LENGTH MAX.	PART NUMBER	GRIP RANGE	SHEAR LBS	TENSILE LBS	QTY. M	WT. LBS					
1/8"	.129-.133	.076	.395	.170	.337	B/SS43SH	.020-.087	.260	.310	10	43					
3.2	#30				.525	B/SS46SH	.188-.375			10	49					

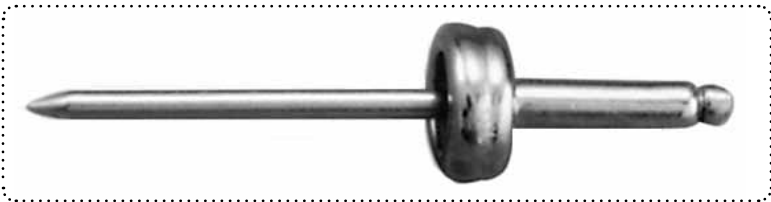

Special nose piece required.



1.800.BUY.RIVET